

Model: Sentinel

Our *Sentinel* electronic chart recorder (1, 2 or 3 pens) is a **low maintenance** instrument, built for **rugged** conditions and designed for **flexibility**, with **programmable channels**, which can be installed and calibrated **simply** and **quickly**, **maximising** your productivity.

General Specification

Security:	3-level software lock including password protection, internal hardware jumper lock, lockable door.
Power Supply:	115V or 230 Vac $\pm 10\%$, switch selectable, 50/60Hz
Case:	Steel case with acrylic window
Protection:	IP55
Mounting:	Panel or Surface
Weight:	7 kg (single pen) / 7.7 kg (three pen)
Panel Cut-Out:	336 x 396 x 171 mm (w x h x d) / 288 x 356 mm (w x h)
Inputs:	Disposable ink cartridges: 1, 2 or 3 pens
Input Signals:	Thermocouples K, T, J, N, E, B, R & S / Platinum RTD (Pt100) 3-wire / DC Voltage $\pm 2V$, +20V / DC current $\pm 2mA$, $\pm 20mA$
Chart Size:	240 mm (9.5") circular paper chart
Chart Speeds:	1 to 24 h. (hourly) / 2 to 31 days (daily)
Relays:	3 for single pen / 6 for 2 & 3 pens.
Relay actions:	Software selectable from: High alarm / Low alarm / Deviation alarm / Control relay (high) / Control relay (low).
Switched current:	6A max
Switched voltage:	30 Vdc, 250 Vac



Sentinel Model

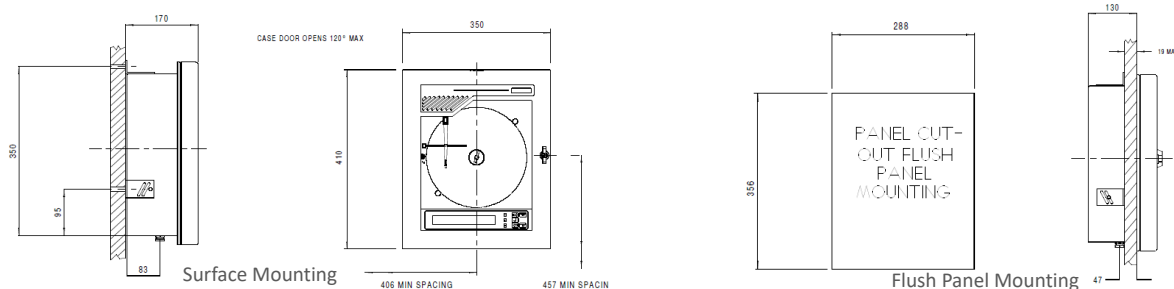

Main Applications

A **world leader** in recorders, Rototherm has become the standard for accurate and reliable measurement across the following industries:



Industrial

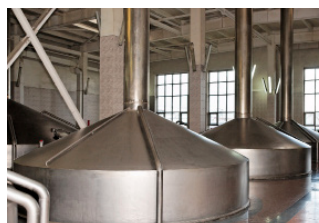

Food & Beverage



HVAC

Ordering Information

Sentinel Recorder	STANDARD →	SEN10	S	A	3	A + XXX	0	0
Model (Channels)	1 pen	SEN10						
	2 pen	SEN20						
	3 pen	SEN30						
Type	Standard		S					
	Flow		F					
Supply & Rotation	230V/ 50Hz/24 Hr			A				
	230V/ 50Hz/7 Day			B				
	230V/ 50Hz/12 Hr			C				
	115V/ 50Hz/24 Hr			D				
	115V/ 50Hz/7 Day			E				
	115V/ 50Hz/12 Hr			F				
	115V/ 60Hz/24 Hr			G				
	115V/ 60Hz/7 Day			H				
	115V/ 60Hz/12 Hr			J				
	Relays	Single Channel				3		
Two Channel					6			
Three Channel					6			
Input, Range & Unit (for Pressure/Temperature) Eg. 0 to 100 deg C	PT100 RTD + Range & Unit					A + XXX		
	Type K T/C + Range & Unit					B + XXX		
	Type J T/C + Range & Unit					C + XXX		
	4-20 mA + Range & Unit					E + XXX		
	0-20 mA + Range & Unit (Please repeat this step for Channel 2 & 3 if required)					F + XXX		
Tx Power Supply	None						0	
	24V Position 1						1	
	24V Position 1 & 2						2	
	24V Position 1, 2 & 3						3	
	12V Position 1						5	
	12V Position 1 & 2						6	
	12V Position 1, 2 & 3						7	
Retransmission	None							0
	0-20mA Channel 1							1
	4-20mA Channel 1							2
	0-20mA Channel 2							3
	4-20mA Channel 2							4
	0-20mA Channel 3							5
4-20mA Channel 3							6	

For any other options, please contact us sales@rototherm.co.uk or +44 (0)1656 740551

Technical Certification

- Certificate of conformity
- Factory Test Certificate
- Factory Calibration Certificate (3 point)
- Factory Calibration Certificate (5 point)
- Material Certificate

Calibration and After-Sales Support

- Fully trained field service personnel
- Use of UKAS certified calibration equipment
- 5 day turnaround
- Fixed pricing
- Approved manufacturer parts
- Full post-service reports
- 12 month warranty



Export Documentation

- Certificate of Origin
- EUR1
- ATR

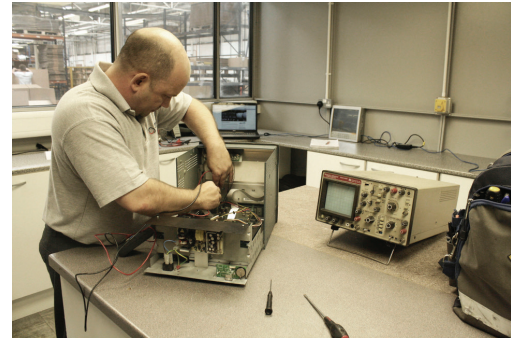

For more information, please contact our service team
services@rototherm.co.uk